

Shown with TA-8 Steel Casing as example.

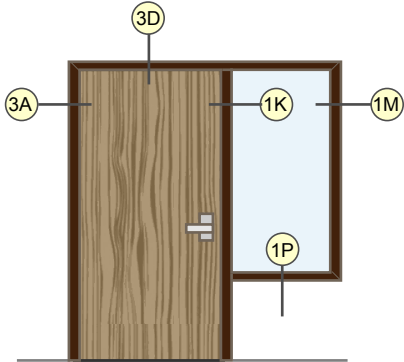

Kerfed Frame - SINGLE with Sidelight Partial Height

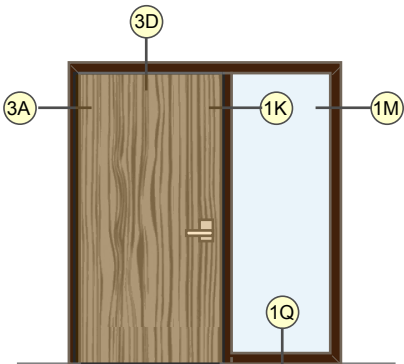

Kerfed Frame - SINGLE with Sidelight Full Height

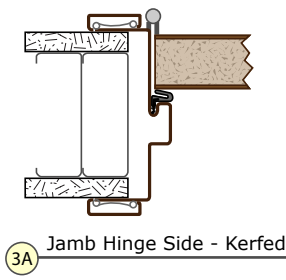

3A Jamb Hinge Side - Kerfed

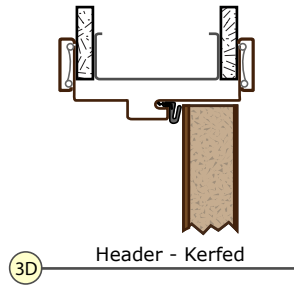

3D Header - Kerfed

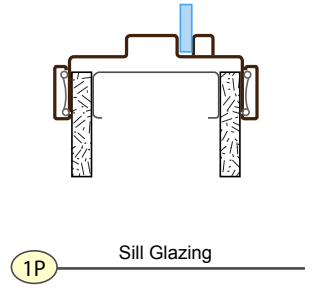

1P Sill Glazing

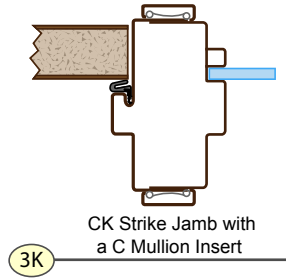

3K CK Strike Jamb with a C Mullion Insert

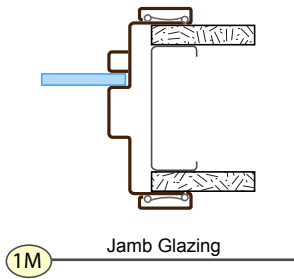

1M Jamb Glazing

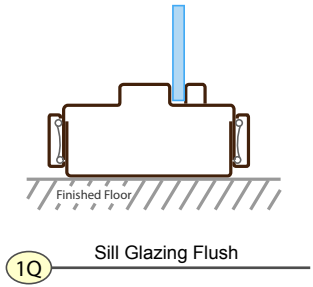

1Q Sill Glazing Flush

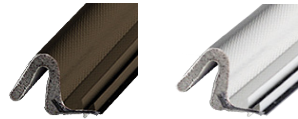

TA-46 Gasket: Weather Strip/Smoke Seal. Available in Browntone and White.

Note: Specify Color and Length.

ROUGH OPENING DIMENSIONS

WIDTH

Opening width area will vary if using a partial height or stepped sidelight. The opening dimension is calculated separately for each "step" in the sidelight.

ROUGH OPENING WIDTH W1: Total of the Nominal Door Width(s) plus 1 1/4"

ROUGH OPENING WIDTH W2: Total of the Nominal Door Width(s) plus the total Net Glass Width(s) plus 2" for each Vertical Mullion plus 1 1/4"

HEIGHT

Opening height equals the net door height. For frames with stepped or partial height sidelights, the light area height is calculated differently than the door area. Measurement is based on calculating the rough opening for the door area first, then measuring from the top down on the sidelight area.

ROUGH OPENING HEIGHT H1: Net Door Opening Height (H) plus 13/16"

ROUGH OPENING HEIGHT H1: Net Glass Height(s) (H) + 2" for each Horizontal Mullion + 1 1/4"

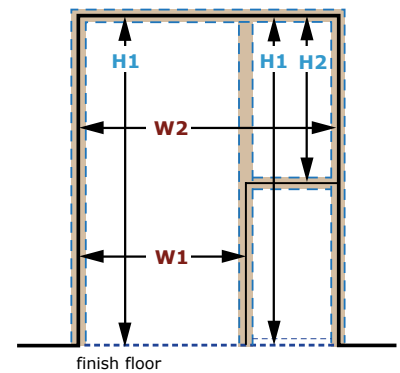

W1 = Nominal Door Width(s) + 1 1/4"

W2 = Nominal Door Width + Net Glass Width(s) + 2" for each Mullion + 1 1/4"

H1 = Net Door Opening Height + 13/16"

H2 = Net Glass Height(s) + 2" for each horizontal Mullion + 1 1/4"

RELATED INFORMATION

FRAME MATERIALS	DOOR SIZE AND WEIGHT	JAMB DEPTH RANGES
Prefinished Steel	Max. Door Weight: 500 Lbs.	Jamb Depths: 4" to 8"
DOOR THICKNESS	Max. Door Width: 4' - 0"	
1 3/4" only	Max. Door Height: 8' - 0"	
FRAME THICKNESS		
18 gauge		

All widths and heights are inside dimensions - net door or glass opening size.

FIRE RATING DOOR AREA

JAMB DEPTH RANGE	20 MINUTE*	45 MINUTE	GENERAL INFORMATION
Min. Jamb Depth: 4"	Max. Width: 4' - 0"	Max. Width: 4' - 0"	<ol style="list-style-type: none"> All openings approved for Positive and Neutral pressure unless otherwise noted. All ratings apply to steel stud, wood stud, or masonry construction. All ratings approved for category "A" and "B" doors with category "G" edge sealing. Timely's fire rated <i>Metal "U" Insert</i> is recommended for masonry installations. If wood subframe is used in place of <i>Metal "U" Insert</i>, it will be necessary to use fire rated drywall on both sides of wood to maintain fire rating. Wood or Aluminum casing does not affect ratings on door frames. Wood casing must be applied with hot melt glue or contact adhesive on 90 minute rated frames and on all glazed openings with 45 minute or 60 minute rating. On all other fire rated frames, wood casing can be applied with nails or finish head screws on jambs and mullions. Single frames must be prepared for strike or reinforced with (TA-47) for a rim exit device strike. Embossed WHI 90 min. label is available for Primer Galvanized Frames only. Metal 90 min. label riveted to frame is available.
Max. Jamb Depth: 8"	Max. Height: 8' - 0"	Max. Height: 8' - 0"	
<p>All dimensions shown are inside dimensions - net door opening size.</p> <p>* Tested and approved for Neutral Pressure only - not Positive Pressure approved.</p> <p>Distributors of Timely Frames may be approved to purchase labels and apply them to frames at their own facility. Intertek has set guidelines and a fee schedule for this program. Requirements and prices are available from Timely or Intertek.</p>			

FIRE RATINGS 45 MINUTE SIDELIGHT AREA

ASSEMBLY	GLASS AREA*	GENERAL INFORMATION
Max. Width: 9' - 7" Max. Height: 9' - 11"	<div style="display: flex; justify-content: space-around;"> <div style="border-left: 1px solid black; border-right: 1px solid black; padding: 0 5px;"> Width: up to 2' Max. Height: 8' - 11" </div> <div style="border-left: 1px solid black; border-right: 1px solid black; padding: 0 5px;"> Width: over 2' up to 3' ** Max. Height: 4' - 6' ** </div> </div> <p>Visible light is 1" less in width and height</p>	<ol style="list-style-type: none"> All openings are approved for Positive and Neutral pressure unless otherwise noted. All ratings apply to steel stud, wood stud, or masonry construction. All ratings approved for category "A" and "B" doors with category "G" edge sealing. Timely's fire rated <i>Metal "U" Insert</i> is recommended for masonry installations. If wood subframe is used in place of <i>Metal "U" Insert</i>, it will be necessary to use fire rated drywall on both sides of wood to maintain fire rating. Aluminum or PVC casing does not affect fire rating. Wood casing must be applied with hot melt glue or contact adhesive on 90 minute rated frames and on all glazed openings with 45 minute or 60 minute rating. On all other fire rated frames, wood casing can be applied with nails or finish head screws on jambs and mullions. Single frames must be prepared for strike plate or reinforced with (TA-12) for a rim exit device strike.
<p>All dimensions shown are inside dimensions - net door opening size.</p> <p>* Multiple Glass Areas can be created with Mullions. The only limitations are Max. Assembly Width and Height.</p> <p>** For glass widths exceeding 24" the maximum glass area is 1296 sq. in. unless approved by local AHJ.</p> <p>Distributors of Timely Frames may be approved to purchase labels and apply them to frames at their own facility. Intertek has set guidelines and a fee schedule for this program. Requirements and prices are available from Timely or Intertek.</p>		