

**CLASSIC FRAME (S-Series & C-Series) - SINGLE w/GLAZING**

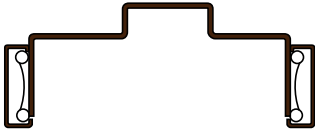

Shown with TA-8 Steel Casing as example.

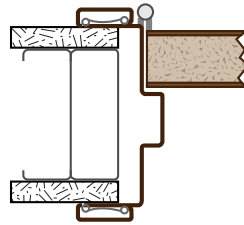

Jamb Hinge Side

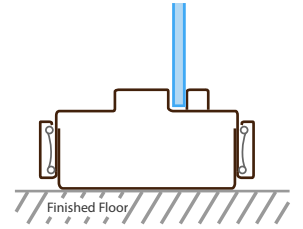

Sill Glazing Flush

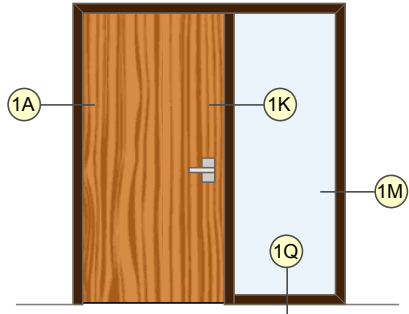

Classic Frame - **SINGLE WITH GLAZING**

1A

1K

1Q

1M

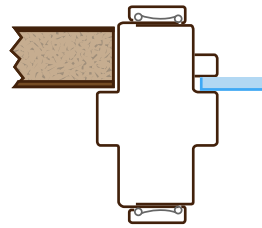

Mullion - Strike Side

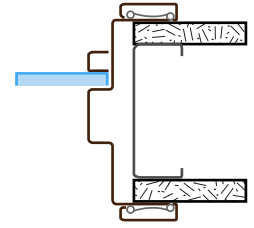

Jamb Glazing

*Single with Glazing* refers to a single door with attached glazing of your design. You are free to add vertical mullions, horizontal mullions, transoms, or steps to the glazed areas.

**CLASSIC FRAME (S-Series & C-Series) - SINGLE w/GLAZING**

**RELATED INFORMATION**

**SOUND**

FRAME MATERIALS	DOOR SIZE AND WEIGHT	JAMB DEPTH RANGES	RATINGS
Pre-Finished Steel	<b>Door Thickness:</b> 1 3/8" or 1 3/4"  <b>Max. Door Weight:</b> 200 lbs.  <b>Max. Door Width:</b> 4' - 0"  <b>Max. Door Height:</b> 12' - 0" **	<b>Standard Jamb Depths</b> <b>S-Series (20 gage) ** :</b> 3 1/2", 3 3/4", 4", 4 5/8", 4 7/8", 5" and 5 3/8" <b>C-Series (18 gage):</b> 3 1/2", 3 3/4", 4", 4 5/8", 4 7/8", 5", 5 3/8", 6 5/8", 6 7/8" and 7 1/4"  <b>Custom Jamb Depths</b> <b>C-Series (18 gage):</b> 3 1/2" to 13" in 1/8" increments.  <b>Max. Mullion Length:</b> 10' - 1"	Not Available
MAX ASSEMBLY SIZE			
<b>Max. Assembly Width:</b> 12' - 0" * (for Standard Jamb Depths) 10' - 1" * (for Custom Jamb Depths)  <b>Max. Assembly Height:</b> 10' - 1"			

\* Wider assemblies will have splice joints in frame and casing.  
 \*\* Mullions are always supplied in 18 gage.

All widths and heights are inside dimensions - net door or glass opening size.

**CLASSIC FRAME (S-Series & C-Series) - SINGLE w/GLAZING**

**FIRE RATING 45 MINUTE**

ASSEMBLY	DOOR AREA	GLASS AREA*	GENERAL INFORMATION
<b>Max. Width:</b> 9' - 7"  <b>Max. Height:</b> 9' - 11"	<b>Max. Door Width:</b> 4' - 0"  <b>Max. Door Height:</b> 9' - 0"	<b>Width:</b> up to 2'  <b>Max. Height:</b> 8' - 11"  Visible light is 1" less in width and height	<b>Width:</b> over 2' up to 3' **  <b>Max. Height:</b> 4' - 6' **

All dimensions shown are inside dimensions - net door opening size.

\* Multiple Glass Areas can be created with Mullions. The only limitations are Max. Assembly Width and Height.  
 \*\* For glass widths exceeding 24" the maximum glass area is 1296 sq. in. unless approved by local AHJ.

Distributors of Timely Frames may be approved to purchase labels and apply them to frames at their own facility. Intertek has set guidelines and a fee schedule for this program. Requirements and prices are available from Timely or Intertek.

- All openings are approved for Positive and Neutral pressure unless otherwise noted.
- All ratings apply to steel stud, wood stud, or masonry construction.
- All ratings approved for category "A" and "B" doors with category "G" edge sealing.
- Timely's fire rated *Metal "U" Insert* is recommended for masonry installations. If wood subframe is used in place of *Metal "U" Insert*, it will be necessary to use fire rated drywall on both sides of wood to maintain fire rating.
- Aluminum or PVC casing does not affect fire rating. Wood casing must be applied with hot melt glue or contact adhesive on 90 minute rated frames and on all glazed openings with 45 minute or 60 minute rating. On all other fire rated frames, wood casing can be applied with nails or finish head screws on jambs and mullions.
- Single frames must be prepared for strike plate or reinforced with (TA-12) for a rim exit device strike.