

Shown with TA-8 Steel Casing as example.

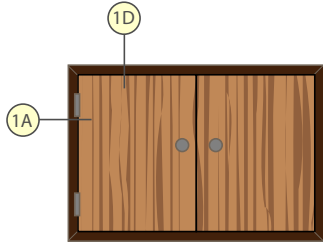

CLASSIC FRAME - PAIR ACCESS

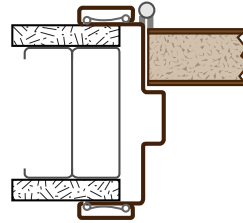

1A

Jamb Hinge Side

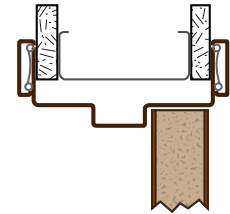

1D

Header

RELATED INFORMATION

SOUND FIRE RATING

FRAME MATERIALS	DOOR SIZE AND WEIGHT	JAMB DEPTH RANGES	RATINGS	RATINGS
Prefinished Steel	<p>Door Thickness: 1 3/8" or 1 3/4"</p> <p>Max. Door Width: 2 x 4' - 0"</p> <p>Max. Door Height: 10' - 0" *</p> <p>Max. Door Weight: 200 Lbs. each</p>	<p>Standard Jamb Depths S-Series (20 gauge): 3 3/4", 4 5/8", 4 7/8", 5" and 5 3/8"</p> <p>C-Series (18 gauge): 3 1/2", 3 3/4", 4", 4 5/8", 4 7/8" 5", 5 3/8", 6 5/8", 6 7/8" and 7 1/4"</p> <p>Custom Jamb Depths: C-Series (18 gauge): 2 5/8" to 13" in 1/8" increments</p>	Not Available	Not Available
<p>* Height on custom Jamb Depths is limited to 10' - 1" All widths and heights are inside dimensions - net door or glass opening size.</p>				

ROUGH OPENING DIMENSIONS

WIDTH

For a Pair access door frame, the rough opening width is 1 1/4" larger than the total of the nominal door widths.

Width is total nominal door widths plus astragal between doors (if used)

ROUGH OPENING: Nominal Door widths + 1 1/4"

HEIGHT

For Single access door, the rough opening height is 1 1/4" larger than the nominal door height.

Height is the net inside dimension of the frame

ROUGH OPENING: Door height + 1 1/4"

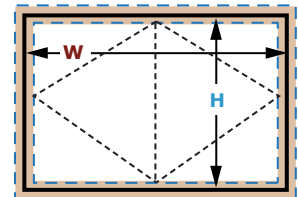

W = Width of doors + astragal (if used) + 1 1/4"

H = Nominal Height (net inside frame dimension) + 1 1/4"