

Shown with TA-8 Steel Casing as example.

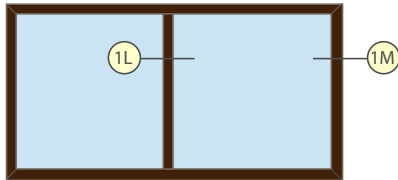

CLASSIC FRAME - BORROWED LIGHT

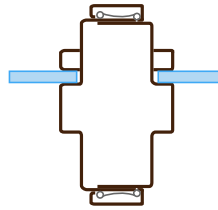

Mullion Glazing

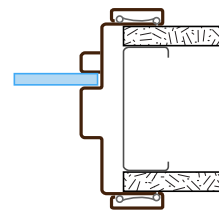

Jamb Glazing

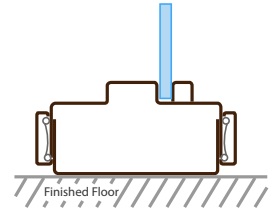

Sill Glazing Flush

**Borrowed Light** refers to a glazed area of your design not attached to a door. You are free to add vertical mullions, horizontal mullions or steps to the glazed area.

RELATED INFORMATION

SOUND

FRAME MATERIALS	DOOR SIZE	JAMB DEPTH RANGES	RATINGS
Prefinished Steel	<b>Frame Materials:</b> Pre-Finished Steel  <b>Max. Assembly Width:</b> 12' - 0" * (for Standard Jamb Depths) 10' - 1" * (for Custom Jamb Depths)  <b>Max. Assembly Height:</b> 12' - 0" ** (for Standard Jamb Depths) 10' - 1" ** (for Custom Jamb Depths)	<b>Standard Jamb Depths</b> <b>S-Series (20 gauge) ***:</b> 3 3/4", 4 5/8", 4 7/8", 5" and 5 3/8"  <b>C-Series (18 gauge):</b> 3 1/2", 3 3/4", 4", 4 5/8", 4 7/8", 5", 5 3/8", 6 5/8", 6 7/8" and 7 1/4"  <b>Custom Jamb Depths</b> <b>C-Series (18 gauge):</b> 2 5/8" to 13" in 1/8" increments. <b>Mullion:</b> 3 3/8" to 13" in 1/8" increments. <b>Max. Mullion Length:</b> 10' - 1"	Not Available

All widths and heights are inside dimensions - net glass opening size.

- \* Wider assemblies will have splice joints in frame and casing.
- \*\* Height on custom Jamb Depths is limited to 10' - 1"
- \*\*\* Mullions are always supplied in 18 gage.

FIRE RATINGS 45 MINUTE

Min. Jamb Depth: 3 1/2" — Max. Jamb Depth: 13"			GENERAL INFORMATION
ASSEMBLY	GLASS AREA*		<ol style="list-style-type: none"> <li>All openings are approved for Positive and Neutral pressure unless otherwise noted.</li> <li>All ratings apply to steel stud, wood stud, or masonry construction.</li> <li>All ratings approved for category "A" and "B" doors with category "G" edge sealing.</li> <li>Timely's fire rated <i>Metal "U" Insert</i> is recommended for masonry installations. If wood subframe is used in place of <i>Metal "U" Insert</i>, it will be necessary to use fire rated drywall on both sides of wood to maintain fire rating.</li> <li>Aluminum casing does not affect fire rating. Wood casing on perimeter does not affect fire rating. Wood casing on mullions limits fire rating to 20 min. Wood casing on perimeter with TA-8 casing on mullion does not affect fire rating. Wood casing must be applied with hot melt glue or contact adhesive on 90 minute rated frames and on all glazed openings with 45 minute or 60 minute rating. On all other fire rated frames, wood casing can be applied with nails or finish head screws on jambs and mullions.</li> </ol>
<b>Max. Width:</b> 10' - 1"	<b>Width:</b> up to 2'	<b>Width:</b> from 2' up to 3'**	
<b>Max. Height:</b> 10' - 1"	<b>Max. Height:</b> 8' - 11"	<b>Max. Height:</b> 4' - 6'**	

All dimensions shown are inside dimensions - net door opening size.

\* Multiple Glass Areas can be created with Mullions. The only limitations are Max. Assembly Width and Height.

\*\* For glass widths exceeding 24" the maximum glass area is 1296 sq. in. unless approved by local AHJ.

Distributors of Timely Frames may be approved to purchase labels and apply them to frames at their own facility. Intertek has set guidelines and a fee schedule for this program. Requirements and prices are available from Timely or Intertek.

## ROUGH OPENING DIMENSIONS

### WIDTH

For Borrowed lights, the rough opening width is 1 1/4" larger than the inside glass area, including any mullions. For stepped borrowed lights, the dimension is calculated separately for each step width.

**ROUGH OPENING:** Glass width + 2" for each mullion + 1 1/4"

### HEIGHT

For Borrowed lights, the rough opening height is 1 1/4" larger than the inside glass area, including any mullions. For stepped borrowed lights, the dimension is calculated separately for each step width.

**ROUGH OPENING:** Glass height + 2" for each mullion + 1 1/4"

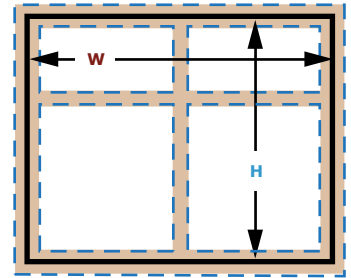

**W** = Net Glass Width(s) + 2"  
for each Mullion + 1 1/4"

**H** = Net Glass Height(s) + 2"  
for each Mullion + 1 1/4"